



Certificate No:00107Q12774R0S/1100

Stud Magnet

Not only can it locate the stud, it can also be used as a nail starter and for a plumb line. Ideal for the do-it-yourself or home improvement customer who needs to hang pictures, shelves or decorations, or anchor items to a stud, this patent pending product is very easy to use, has no mechanical parts, and requires no batteries or calibration. Permanent magnetism guaranteed!

Part No. ME07512 Red Stud Magnet with red shield.

Part No. ME07513 Purple Stud Magnet with green shield.

Part No. ME07514 Orange Stud Magnet with green shield.

ME07512

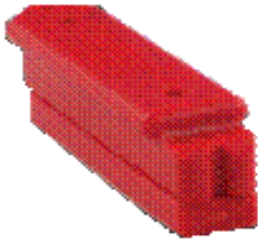

ME07513

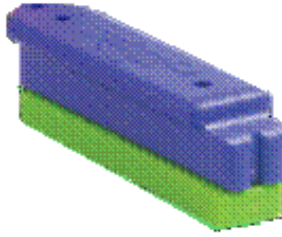

ME07514

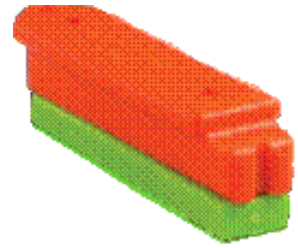

- Remove Magnetic Shield and move magnet against wall to locate drywall screws and nails to locate studs.
- Set nail in notched end for easy start up.
- Attach string and use as a plumb line guide for additional nails or screws.

1



2



3



Nail holder

